

Automatic Ball Drip

A58



► To drain low point of system between swing check valve and Fire Dept. connection. Automatically seals under pressure. Must be installed in vertical position only.

MALE x MALE

Standard equipment:
Cast brass straight connection male NPT both.

a	b
1/2"	1/2"
3/4"	3/4"

	1/2"	3/4"
A	2-11/16"	2-11/16"

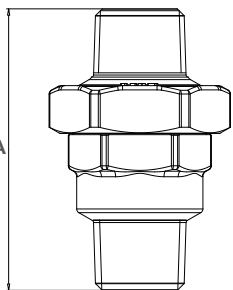

Line-tester

A59



► For installing the last sprinkler head on system branch lines, controls water flow for flushing or testing of the system.

Available with NPT Threads.

CERTIFICATIONS



a	b	c
1"	1"	1/2"

	1" x 1"
A	1-11/32"
B	2-3/16"
C	4"
D	1-1/2"
E	1-9/32"

